

**Plaquettes insert**  
**Inserts**  
**Wendeplatten**

**à gauche**  
**on the left**  
**links**

**734**

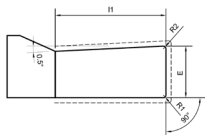
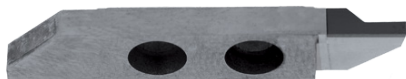

| E    | I1   | R | Ref.    |
|------|------|---|---------|
| 0.50 | 1.50 | 0 | 734-0.5 |
| 0.60 | 1.70 | 0 | 734-0.6 |
| 0.80 | 2.00 | 0 | 734-0.8 |
| 1.00 | 2.50 | 0 | 734-1.0 |
| 1.20 | 2.70 | 0 | 734-1.2 |
| 1.50 | 3.00 | 0 | 734-1.5 |
| 2.00 | 4.00 | 0 | 734-2.0 |
| 2.50 | 5.00 | 0 | 734-2.5 |

**Tourneur arrière**  
**Back turning insert**  
**Hinterdreh Bearbeitung**

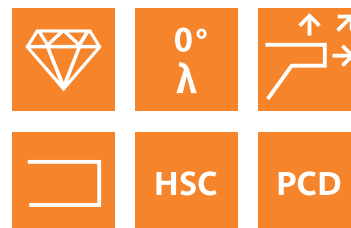

**730** **Porte Outil / Tool Holder / Werkzeug-Halter**



| ∅     | L   | Ref.   |
|-------|-----|--------|
| 7×7   | 115 | 730-7  |
| 8×8   | 115 | 730-8  |
| 10×10 | 115 | 730-10 |
| 12×12 | 130 | 730-12 |
| 16×16 | 130 | 730-16 |



**Plaquettes insert**  
**Inserts**  
**Wendeplatten**

**à gauche**  
**on the left**  
**links**

**734 SP**

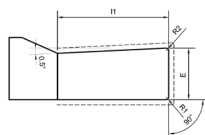
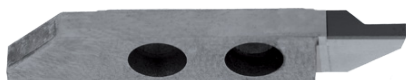

**Tourneur arrière**  
**Back turning insert**  
**Hinterdreh Bearbeitung**

**Demande de prix**  
**Price request**  
**Preis Anfrage**

**Commande**  
**Order**  
**Bestellung**

E \_\_\_\_\_ I1 \_\_\_\_\_

R1 \_\_\_\_\_ R2 \_\_\_\_\_

**Ref. Porte-outil**  
**Tool Holder**  
**Werkzeug-Halter** \_\_\_\_\_

**Matière à usiner**  
**Material to be machined**  
**Werkstoff zum Bearbeiten** \_\_\_\_\_

**Quantité**  
**Quantity**  
**Quantität** \_\_\_\_\_

